

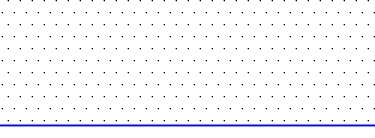

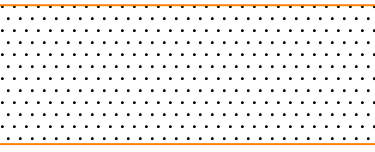

LEGEND

- PHASE 1 SIDEWALK (COMPLETED 2023) 
- PROPOSED PHASE 2 SIDEWALK (2024) 
- PROPOSED PHASE 2 SIDEWALK REMOVAL (NO REPLACEMENT) 
- TREE TO BE REMOVED 

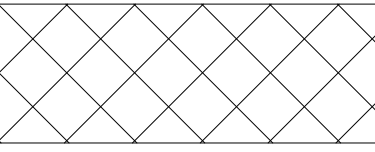

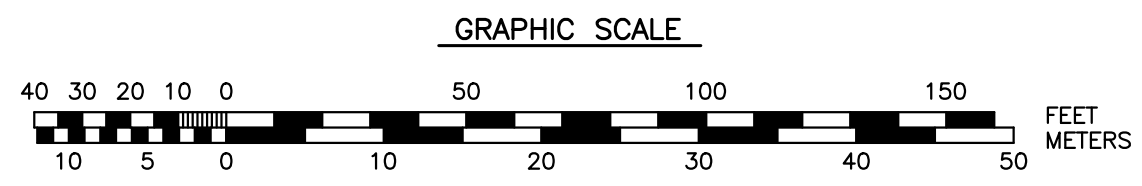
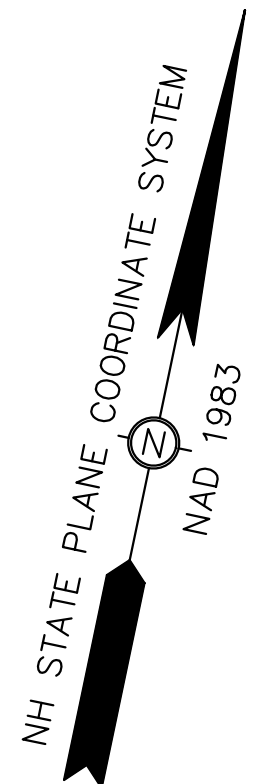
DEPARTMENT OF
PUBLIC WORKS
CITY OF PORTSMOUTH, NH
680 PEVERLY HILL ROAD
603-427-1530

0	ISSUED FOR CONSTRUCTION	MRB	2/12/24
NO.	REVISIONS	APP'D	DATE
PROJECT: 2024 CITYWIDE SIDEWALKS PANNAWAY MANOR			
TITLE: TREE REMOVAL PLAN PHASE 2			
DRAWING SCALE:	AS SHOWN	DATE:	FEBRUARY 2022
PROJECT NO.:	7246	SHEET:	C-220
APPROVED BY:	MRB		

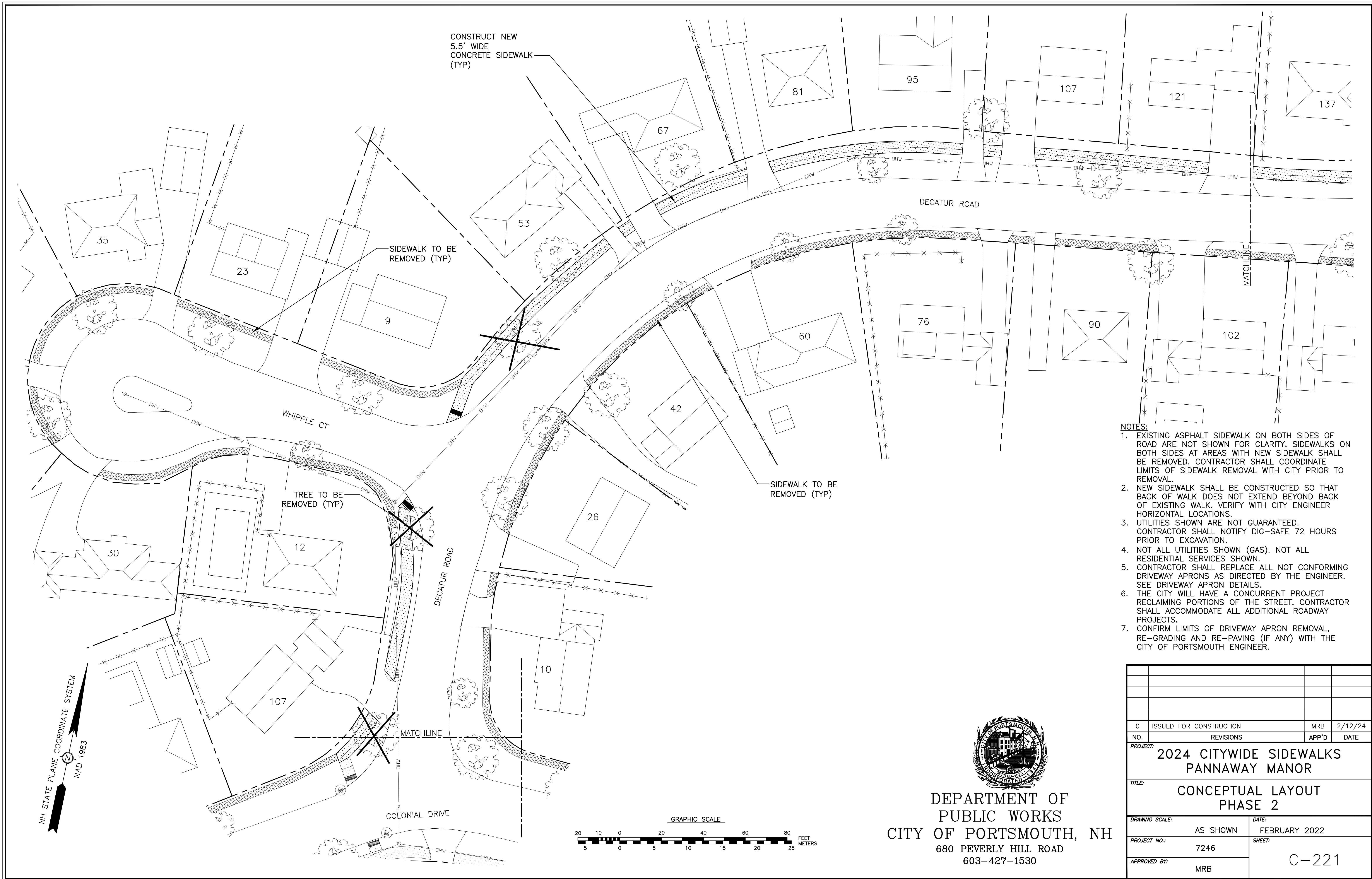

- NOTES:**
- EXISTING ASPHALT SIDEWALK ON BOTH SIDES OF ROAD ARE NOT SHOWN FOR CLARITY. SIDEWALKS ON BOTH SIDES AT AREAS WITH NEW SIDEWALK SHALL BE REMOVED. CONTRACTOR SHALL COORDINATE LIMITS OF SIDEWALK REMOVAL WITH CITY PRIOR TO REMOVAL.
 - NEW SIDEWALK SHALL BE CONSTRUCTED SO THAT BACK OF WALK DOES NOT EXTEND BEYOND BACK OF EXISTING WALK. VERIFY WITH CITY ENGINEER HORIZONTAL LOCATIONS.
 - UTILITIES SHOWN ARE NOT GUARANTEED. CONTRACTOR SHALL NOTIFY DIG-SAFE 72 HOURS PRIOR TO EXCAVATION.
 - NOT ALL UTILITIES SHOWN (GAS). NOT ALL RESIDENTIAL SERVICES SHOWN.
 - CONTRACTOR SHALL REPLACE ALL NOT CONFORMING DRIVEWAY APRONS AS DIRECTED BY THE ENGINEER. SEE DRIVEWAY APRON DETAILS.
 - THE CITY WILL HAVE A CONCURRENT PROJECT RECLAIMING PORTIONS OF THE STREET. CONTRACTOR SHALL ACCOMMODATE ALL ADDITIONAL ROADWAY PROJECTS.
 - CONFIRM LIMITS OF DRIVEWAY APRON REMOVAL, RE-GRADING AND RE-PAVING (IF ANY) WITH THE CITY OF PORTSMOUTH ENGINEER.

0	ISSUED FOR CONSTRUCTION	MRB	2/12/24
NO.	REVISIONS	APP'D	DATE
PROJECT: 2024 CITYWIDE SIDEWALKS PANNAWAY MANOR			
TITLE: CONCEPTUAL LAYOUT PHASE 2			
DRAWING SCALE:	AS SHOWN	DATE:	FEBRUARY 2022
PROJECT NO.:	7246	SHEET:	C-221
APPROVED BY:	MRB		



DEPARTMENT OF
PUBLIC WORKS
CITY OF PORTSMOUTH, NH
680 PEVERLY HILL ROAD
603-427-1530

NH STATE PLANE COORDINATE SYSTEM
NAD 1983

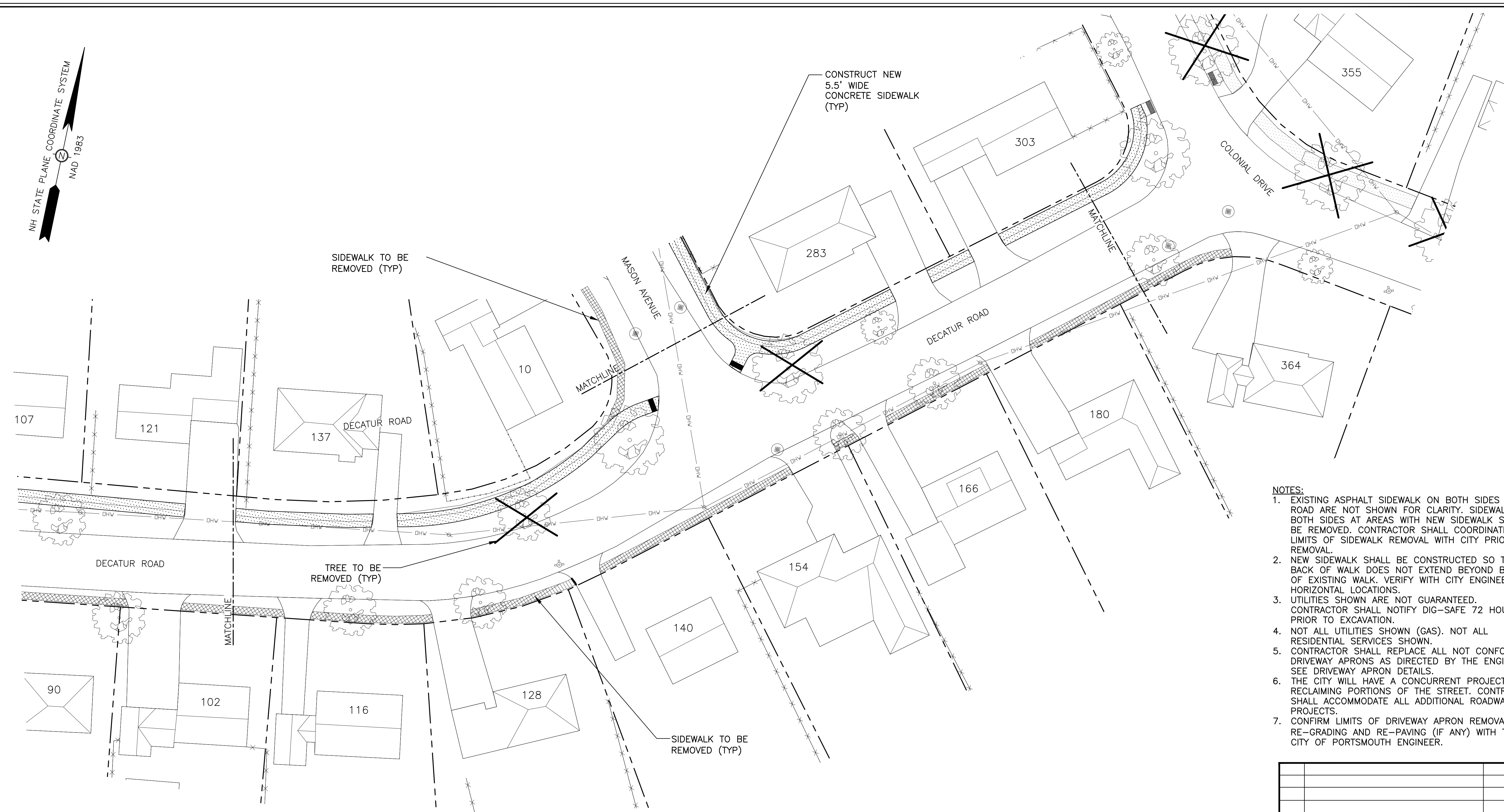

- NOTES:**
- EXISTING ASPHALT SIDEWALK ON BOTH SIDES OF ROAD ARE NOT SHOWN FOR CLARITY. SIDEWALKS ON BOTH SIDES AT AREAS WITH NEW SIDEWALK SHALL BE REMOVED. CONTRACTOR SHALL COORDINATE LIMITS OF SIDEWALK REMOVAL WITH CITY PRIOR TO REMOVAL.
 - NEW SIDEWALK SHALL BE CONSTRUCTED SO THAT BACK OF WALK DOES NOT EXTEND BEYOND BACK OF EXISTING WALK. VERIFY WITH CITY ENGINEER HORIZONTAL LOCATIONS.
 - UTILITIES SHOWN ARE NOT GUARANTEED. CONTRACTOR SHALL NOTIFY DIG-SAFE 72 HOURS PRIOR TO EXCAVATION.
 - NOT ALL UTILITIES SHOWN (GAS). NOT ALL RESIDENTIAL SERVICES SHOWN.
 - CONTRACTOR SHALL REPLACE ALL NOT CONFORMING DRIVEWAY APRONS AS DIRECTED BY THE ENGINEER. SEE DRIVEWAY APRON DETAILS.
 - THE CITY WILL HAVE A CONCURRENT PROJECT RECLAIMING PORTIONS OF THE STREET. CONTRACTOR SHALL ACCOMMODATE ALL ADDITIONAL ROADWAY PROJECTS.
 - CONFIRM LIMITS OF DRIVEWAY APRON REMOVAL, RE-GRADING AND RE-PAVING (IF ANY) WITH THE CITY OF PORTSMOUTH ENGINEER.

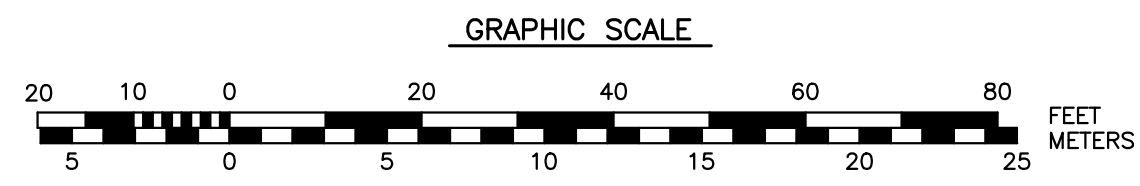

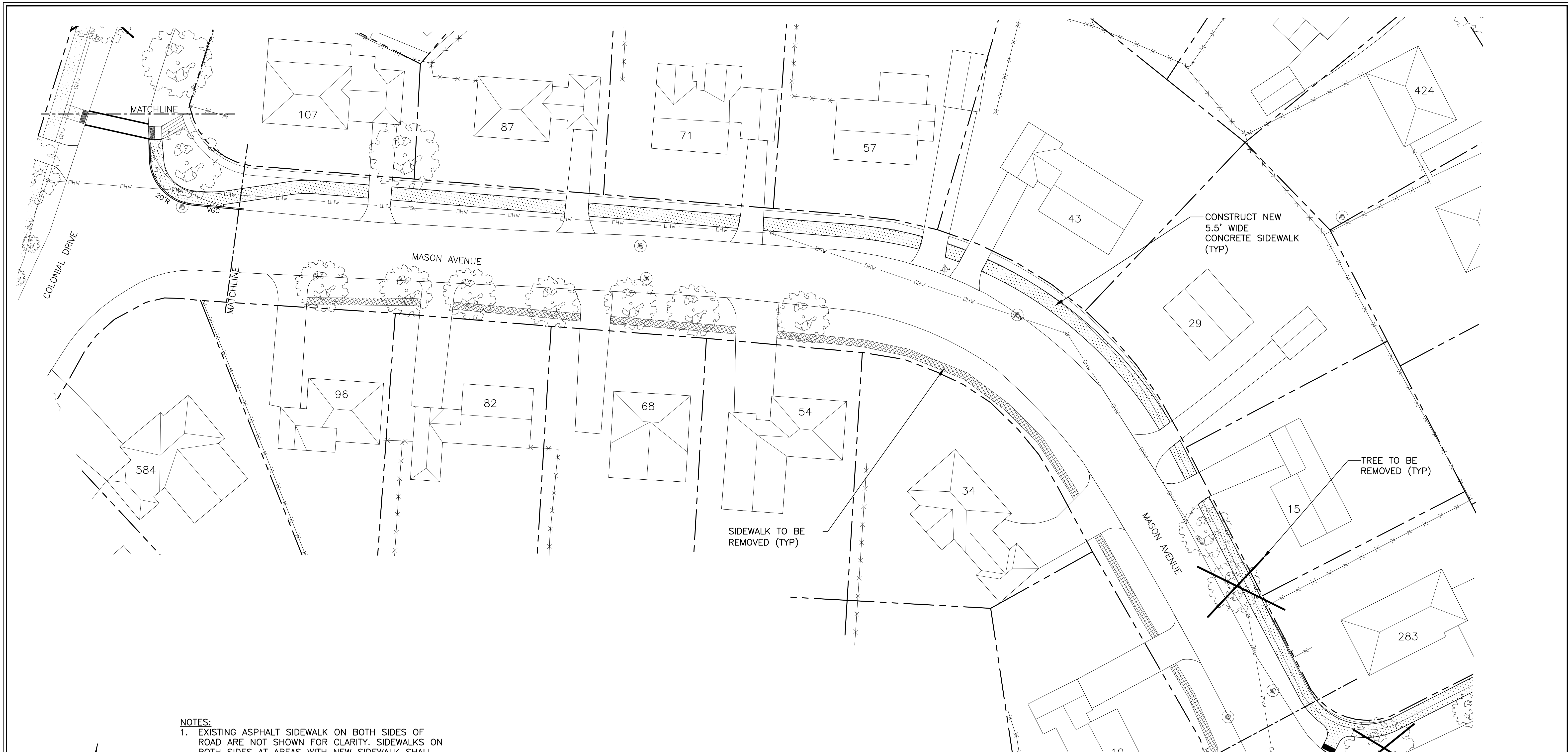

DEPARTMENT OF
PUBLIC WORKS
CITY OF PORTSMOUTH, NH
680 PEVERLY HILL ROAD
603-427-1530

0	ISSUED FOR CONSTRUCTION	MRB	2/12/24
NO.	REVISIONS	APP'D	DATE
PROJECT: 2024 CITYWIDE SIDEWALK PANNAWAY MANOR			
TITLE: CONCEPTUAL LAYOUT PHASE 2			
DRAWING SCALE:	AS SHOWN	DATE:	FEBRUARY 2022
PROJECT NO.:	7246	SHEET:	C-222
APPROVED BY:	MRB		

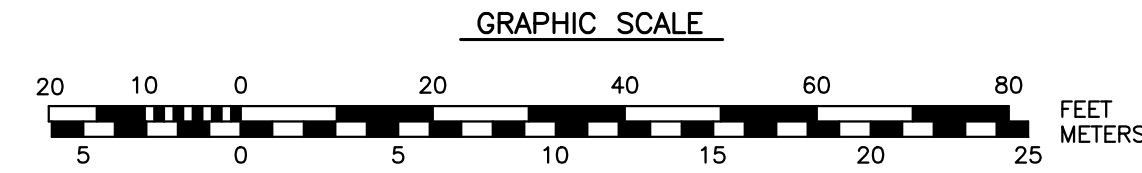
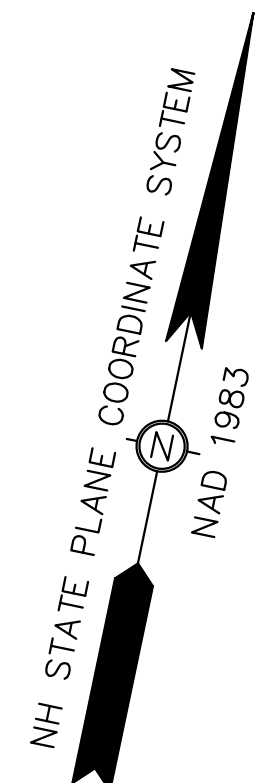

- NOTES:**
- EXISTING ASPHALT SIDEWALK ON BOTH SIDES OF ROAD ARE NOT SHOWN FOR CLARITY. SIDEWALKS ON BOTH SIDES AT AREAS WITH NEW SIDEWALK SHALL BE REMOVED. CONTRACTOR SHALL COORDINATE LIMITS OF SIDEWALK REMOVAL WITH CITY PRIOR TO REMOVAL.
 - NEW SIDEWALK SHALL BE CONSTRUCTED SO THAT BACK OF WALK DOES NOT EXTEND BEYOND BACK OF EXISTING WALK. VERIFY WITH CITY ENGINEER HORIZONTAL LOCATIONS.
 - UTILITIES SHOWN ARE NOT GUARANTEED. CONTRACTOR SHALL NOTIFY DIG-SAFE 72 HOURS PRIOR TO EXCAVATION.
 - NOT ALL UTILITIES SHOWN (GAS). NOT ALL RESIDENTIAL SERVICES SHOWN.
 - CONTRACTOR SHALL REPLACE ALL NOT CONFORMING DRIVEWAY APRONS AS DIRECTED BY THE ENGINEER. SEE DRIVEWAY APRON DETAILS.
 - THE CITY WILL HAVE A CONCURRENT PROJECT RECLAIMING PORTIONS OF THE STREET. CONTRACTOR SHALL ACCOMMODATE ALL ADDITIONAL ROADWAY PROJECTS.
 - CONFIRM LIMITS OF DRIVEWAY APRON REMOVAL, RE-GRADING AND RE-PAVING (IF ANY) WITH THE CITY OF PORTSMOUTH ENGINEER.



**DEPARTMENT OF
PUBLIC WORKS**
CITY OF PORTSMOUTH, NH
 680 PEVERLY HILL ROAD
 603-427-1530

0	ISSUED FOR CONSTRUCTION	MRB	2/12/24	
NO.	REVISIONS	APP'D	DATE	
PROJECT: 2024 CITYWIDE SIDEWALKS PANNAWAY MANOR				
TITLE: CONCEPTUAL LAYOUT PHASE 2				
DRAWING SCALE: AS SHOWN		DATE: FEBRUARY 2022		
PROJECT NO.: 7246		SHEET: C-223		
APPROVED BY: MRB				